

# Stage 1

GROUND FLOOR

Total of 677 m<sup>2</sup> (7,287 sq ft)

Stage 1 423 m<sup>2</sup> (4,553 sq ft)

Foyer 144 m<sup>2</sup> (1,550 sq ft)

Stage 110 m<sup>2</sup> (1,184 sq ft)

Gallery 41 m<sup>2</sup> (441 sq ft)

23,5 m x 18 m (77 x 59 ft)

Hight 6,23 m (20.4 ft)

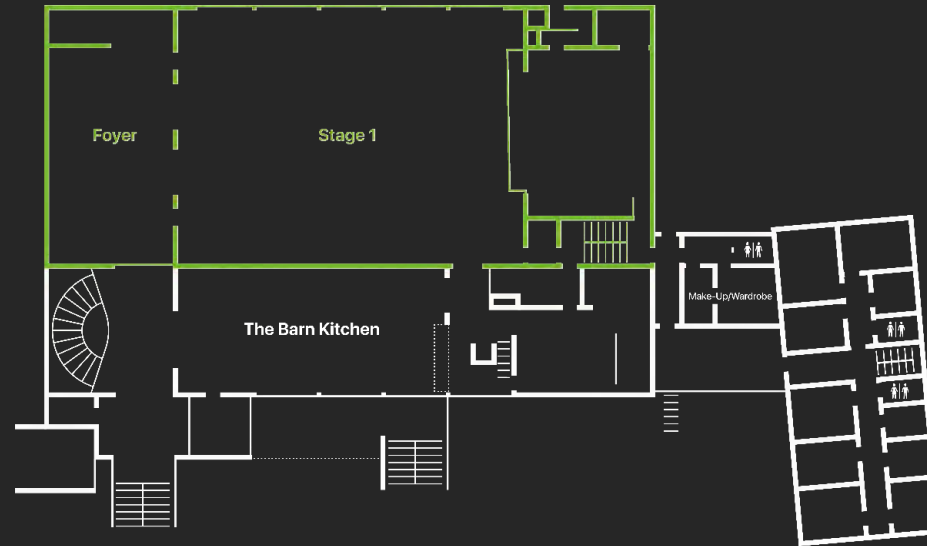

## Specifications

- wooden floors
- air ventilation system, heating
- large glass windows for daylight and views
- High-Speed Internet: Ethernet and Wi-Fi
- 2x 63A CEE wall outlet à 400V
- Lighting Grids (max. weight capacity 2x 1.000 kg/2,200 lbs)
- 8 Fresnel lights, 4 profiler, 4 moving lights (DMX)
- Control Room (MA lighting controller)
- Fohn Line Source sound system
- 360-degree duvetyn curtain system
- 6k Beamer/ Rear Projection Screen
- separate stage incl. automated curtain system and rigs
- fully accessible on ground floor
- Gallery on first floor with separate access